



Idealite Offset Quadrant Flat Top RH Offset Shower Tray, 900x800mm & Waste

Illustrated

L6329 Idealite Offset Quadrant right hand low profile shower tray 900 x 800mm with waste

Configuration options

L6308 Flexible waste pipe

LV69967 Shower tray adhesive upstand

Material

Acrylic Capped ABS and Polymer Resin

Standards

EN14527:2006 + A1:2010

Weights

L6329 6.76KG

Special Notes

Ensure correct hand chosen. Not recommended for riser installations.

Colours

White (01)

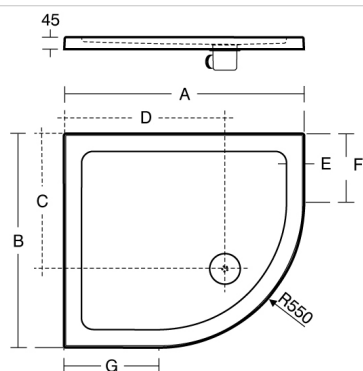

		A	B	C	D	E	F	G
L6329	900 x 800 RH	810	910	510	610	67	260	360
L6330	900 x 800 LH	910	810	610	510	67	360	260
L6331	1200 x 900 RH	910	1210	610	910	67	360	660
L6332	1200 x 900 LH	1210	910	910	610	67	660	360
L6630	1000 x 800 RH	810	1010	510	710	67	260	460
L6631	1000 x 800 LH	1010	810	710	510	67	460	260
L6632	1200 x 800 RH	810	1210	510	910	67	260	660
L6633	1200 x 800 LH	1210	810	910	510	67	660	260

Frequently used applications

General Healthcare

Hotels

Residential

Social Housing

Student Accommodation



Tel: 0870 122 8822
Fax: 0870 122 8282
Email: info@idealspec.co.uk
Web: www.idealspec.co.uk

Ideal Standard (UK) Ltd. makes every effort to ensure that the information provided on its website is accurate. However, we cannot guarantee this, and accept no liability for any information or advice given via its website.



Date created: 27/02/2015